

4-Channel 1080P Cabinet Debugging Monitor

SG SG EMO-17304

Product Specification Documents

Ver 1.0



▲ Physical Reference

深圳市瑞众科技有限公司
SHENZHEN RUIZHONG TECHNOLOGY CO., LTD.

Product Description

ShenGong SG EMO-17304 4-way 1080P cabinet debugging display integrates LED display, ultra-thin keyboard, mouse touchpad, set in 1U height unit, the use of drawer installation method, completely solves the space shortage of standard keyboard, monitor, and mouse compared to saving 85% space. High-quality Class A 17.3 "LED (no highlights) display, built-in switch can directly manage 4 servers; Up to 128 servers can be managed.

Main features

★ Support 4 HDMI signal inputs, a single group of control terminal management 4 servers, can cascade multiple devices, can manage up to 128 computers.

★ 17.3" LED screen, keyboard and mouse integration, single double slide body, only 1U rack space; 17.3 inches LED LCD display, high brightness, high definition, resolution up to 1920x1080@60Hz.

★ Effectively save room space, when the keyboard/trackpad is not needed, it can be pushed back into the rack, only the thin LED display is retained to facilitate the management to monitor the status of the server, and the guide rail is equipped with self-locking device.

★ Support hot swap - Add or remove servers at any time without turning off the power.

★ Provide automatic scanning mode and sustainable monitoring of the user's selected host.

★ Drawer type, USB HUB function can be realized through the front USB2.0 interface.

★ Easily switch between servers with hotkeys and panel keys.

Product Connection Diagram

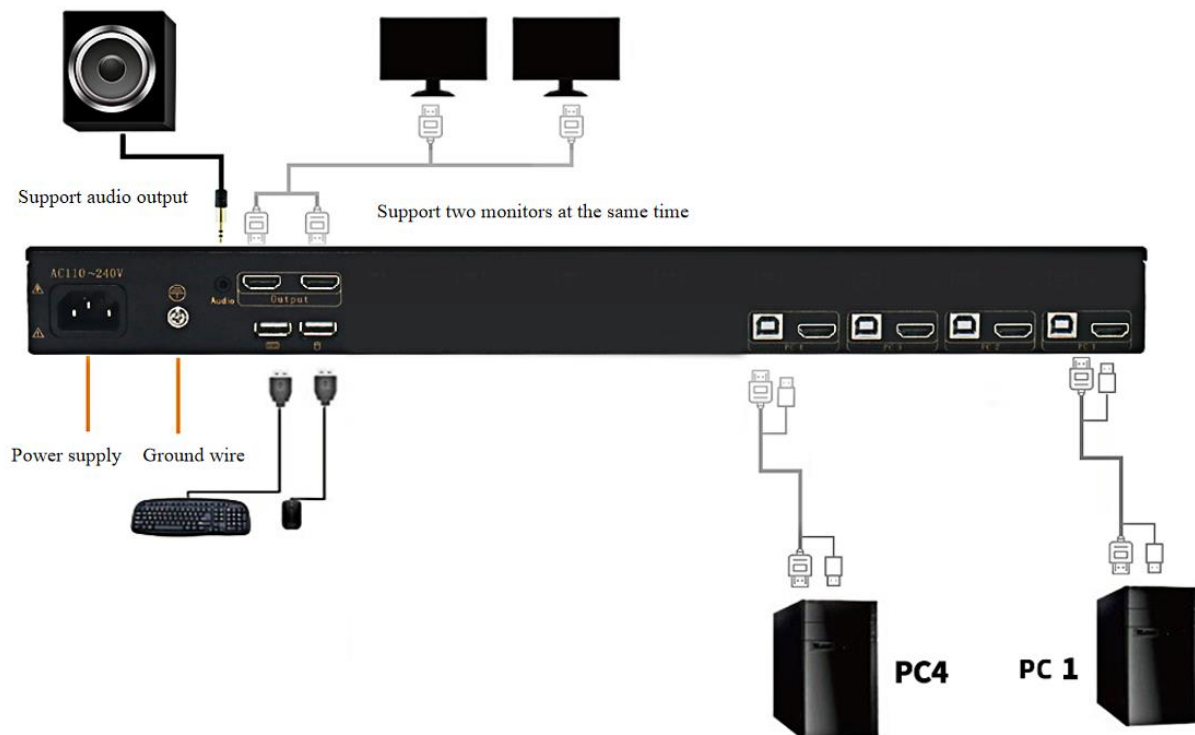

Technical specifications

Model: SG EMO-17304

Accessories: Includes 2 mounting ears, 4 KVM cables (1.8 meters), optional 3-meter and 5-meter cables available

Computer Connection: 4 computers

Maximum Computer Connection: 128 computers

Connection Ports: HDMI interface (3*USB for keyboard and mouse)



Switching Scan Time:	1-255 seconds (adjustable via OSD)
Applicable Cabinet:	800-1040MM
Switching Method:	Hotkey switching, button switching
LED Display:	Size: 17.3" LED Resolution: 1920*1080@60Hz Brightness: 300 nits Contrast Ratio: 1000:1
LED Display Control:	Multi-language OSD adjustment for optimal performance
Keyboard /Mouse:	104-key mechanical silent keyboard Touchpad
Voltage Input:	A110V-240V 50Hz-60Hz Power Consumption: 35W
Material:	High-strength anti-corrosion steel plate
Exterior Color:	Insulated black paint
Dimensions (L*W*H) :	550mm (depth) * 481mm (width) * 43.8mm (height)
Gross Weight:	17.5KG
Storage Temperature:	-30°C~70°C
Operating Temperature:	-10°C~60°C
Humidity:	0%-80%/RH
